

Clamping Bracket for Surface/Mounted Clamping Modules

Black Nitrided



Clamping flanges are used to fasten raised/mounted clamping modules on the machine table. See pages 56–57.

- Special clamping flanges for various T-slot tables
- Clamping flange and housing manufactured as a single piece

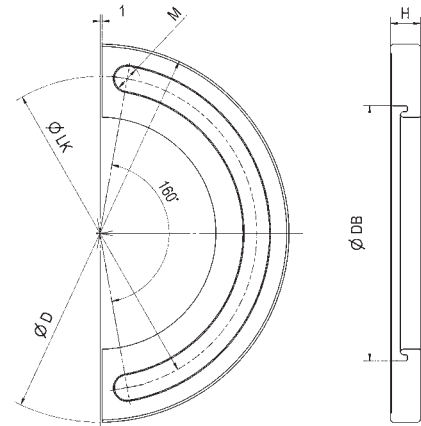

Stainless Steel

Part Number	Size	Pieces Per Module	ØD	ØDB	H	ØLK	M	g
426825	10	2	114	77.5	7.75	94	8.5	180
426833	20	2	164	110.0	13.00	136	11.0	400
426841	40	2	202	146.0	16.00	172	13.0	550

All linear dimensions in (mm)

Flange Type Installation Modules with Centering and Cover Rings



Features:

- Oil supply by pipes or manifolds
- Integrated centering
- Provided as assembled unit

Benefits:

- Simple design and manufacturing of adaptor plate
- Weight saving due to less thickness for adaptor plate
- Easy to adapt to existing mounting angles and cubes

Installation comparison

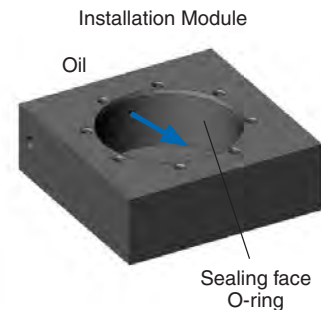
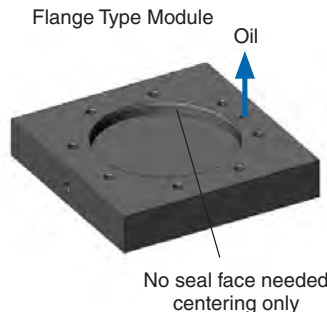
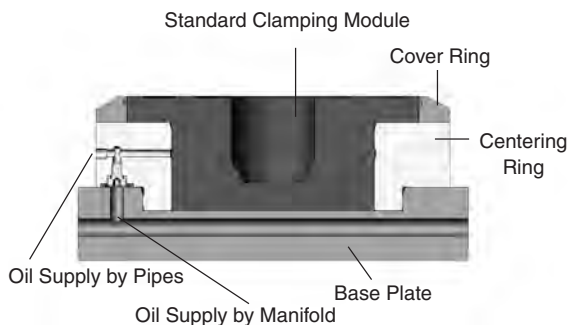

QUICK CHANGE FIXTURING » ZERO POINT MOUNTING SYSTEM